

SB Series – Triaxial



Features

- High performance
- Rigorous design

Applications

- Professional TV Camera
- Broadcasting Industry

SB-101 Part Numbering (European Standard)



Body Type

- P : Plug
- PFC : Plug Fixed with Clamping Device
- PFC1 : Plug Fixed with Short Clamping Device
- J : Jack
- RC : Receptacle with Clamping Device
- RC1 : Receptacle with Short Clamping Device
- APJF : Adapter (Plug - Jack) Flange

Accessory Code

- 1.0 / 4.5 / 8.7
- 1.0 / 4.5 / 9.4
- 1.4 / 4.5 / 9.4
- 1.4 / 6.6 / 11.3
- 1.4 / 6.6 (for PFC1)

SB-102 Part Numbering (American Standard)

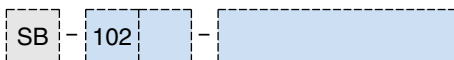

Body Type

- P : Plug
- J : Jack

Accessory Code

- 0.81/3.7/9.5

SB-770 Part Numbering (American Standard)



Body Type

- P : Plug
- J : Jack

Accessory Code

- 0.81/3.7/9.2
- 1.63/7.9/13.2

Major Performances

Specification	101 Model	102 Model	770Model
Impedance	75Ω	75Ω	75Ω
VSWR	<1.2 upto 1.5GHz	<1.2 upto 1GHz	<1.2 upto 1GHz
Contact Resistance	<3mΩ	<3mΩ	<1mΩ
Operating Temperature	-20℃~+70℃	-20℃~+70℃	-20℃~+70℃

Material Used / Finish

Material	101 Model	102 Model	770Model
Body	Brass (Nickel & Chrome III)	Brass (Nickel & Chrome III)	Brass (Nickel & Chrome III)
Contacts	Brass (Gold Plate)	Brass (Gold Plate)	Brass (Gold Plate)
Insulator	PTFE	PTFE	PTFE
Latching Sleeve	Brass (Nickel Plate)	Brass (Nickel Plate)	Beryllium copper (Nickel Plate)
Seal	Silicon Rubber	Silicon Rubber	Silicon Rubber

SB Series Mini-map (European Standard)

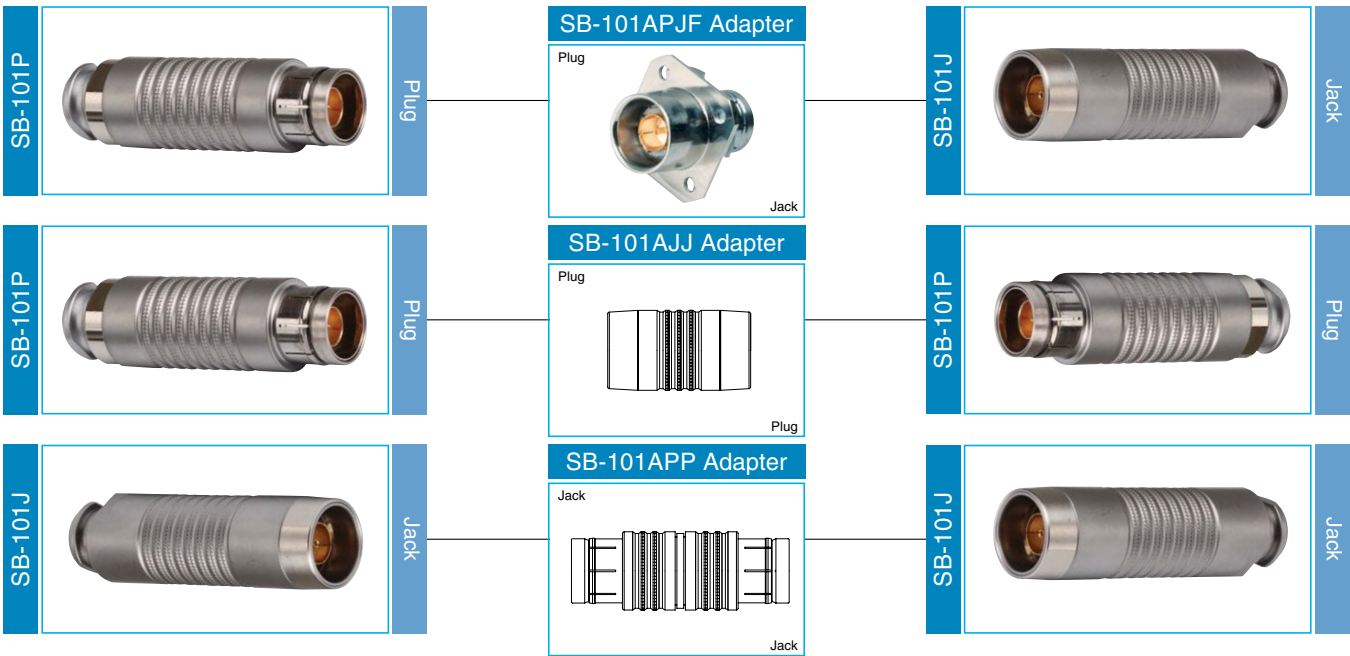
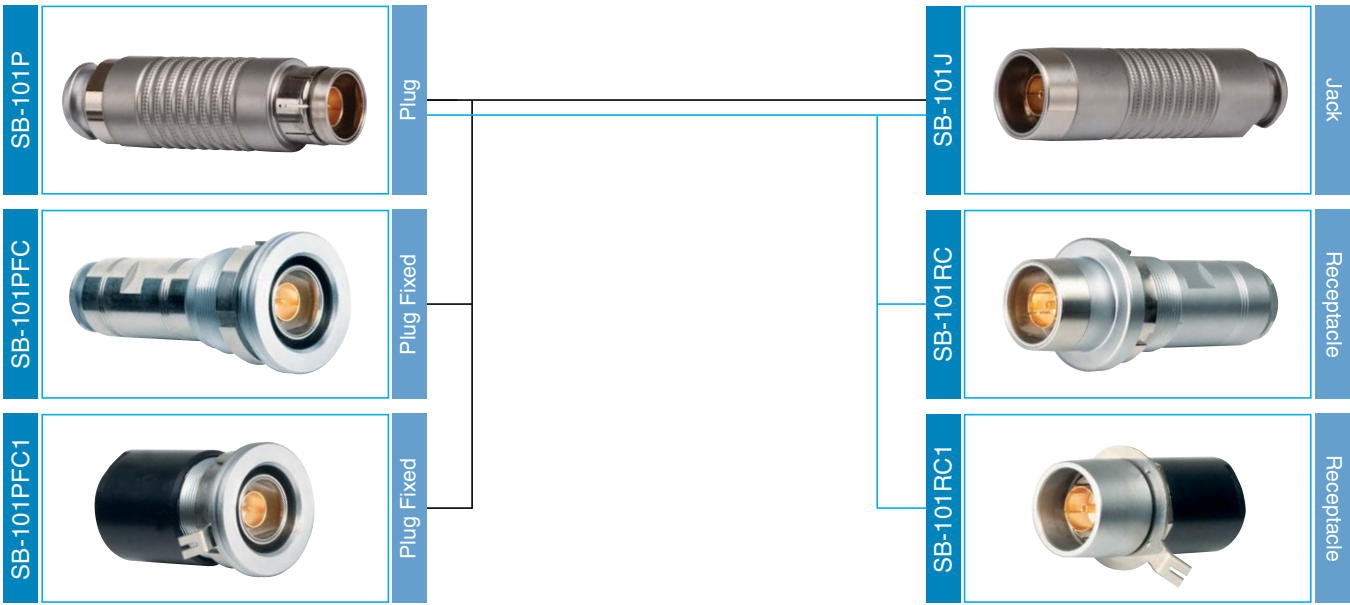

SB Series Mini-map (American Standard)

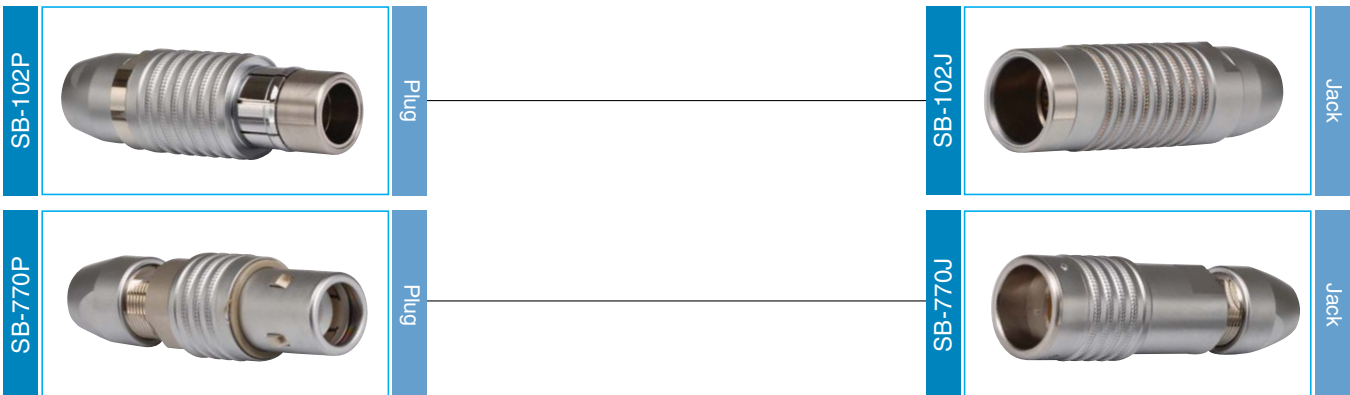

Specifications subject to change without notice. Consult Sam Woo Electronics for the latest specifications.

SB Series – Triaxial

SB-101 Model (European Standard)

Includes accessories.
Accessories available separately.

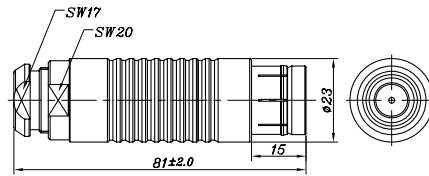

Part Number

SB-101P-1.0/4.5/8.7
SB-101P-1.0/4.5/9.4
SB-101P-1.4/4.5/9.4
SB-101P-1.4/6.6/11.3

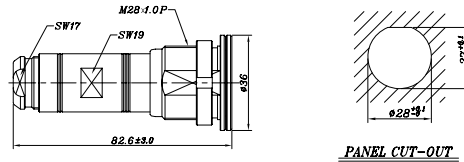

Part Number

SB-101PFC-1.0/4.5/8.7
SB-101PFC-1.0/4.5/9.4
SB-101PFC-1.4/4.5/9.4
SB-101PFC-1.4/6.6/11.3

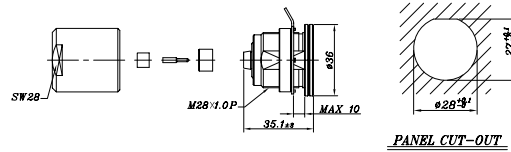

Part Number

SB-101PFC1-1.4/6.6

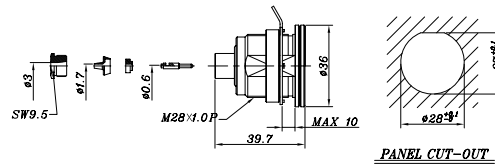
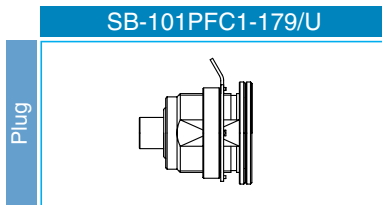

Part Number

SB-101PFC1-179/U

Plug for cable assembly

Part Number

SB-101J-1.0/4.5/8.7
SB-101J-1.0/4.5/9.4
SB-101J-1.4/4.5/9.4
SB-101J-1.4/6.6/11.3

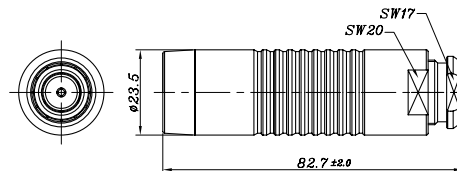

Part Number

SB-101RC-1.0/4.5/8.7
SB-101RC-1.0/4.5/9.4
SB-101RC-1.4/4.5/9.4
SB-101RC-1.4/6.6/11.3

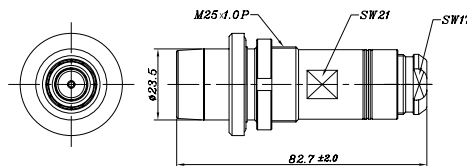

Part Number

SB-101RC1-1.4/6.6

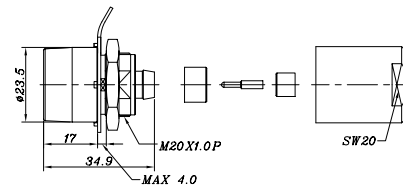

Part Number

SB-101RC1-179/U
Receptacle for cable assembly

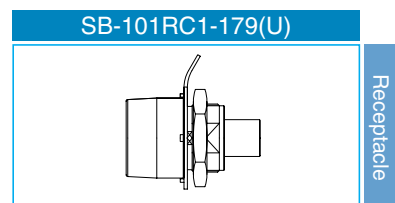
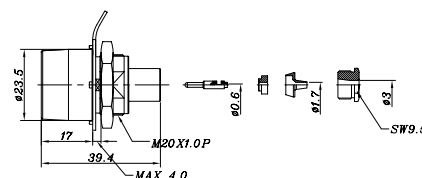

Specifications subject to change without notice. Consult Sam Woo Electronics for the latest specifications.

SB-101 Model (European Standard)

Adapter

SB-101APJF

Adapter

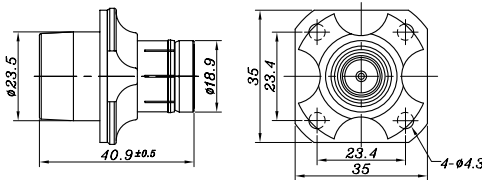

Part Number

SB-101APJF

Adapter : Jack

SB-101APP

Adapter

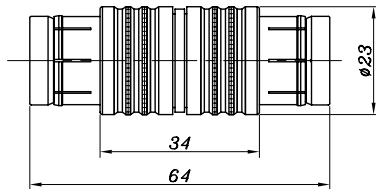
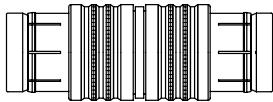

Part Number

SB-101APP

Adapter : Jack + Jack

SB-101AJJ

Adapter

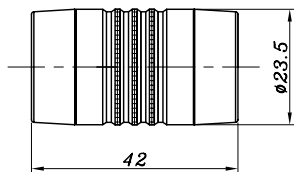
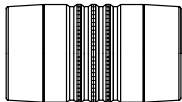

Part Number

SB-101AJJ

Adapter : Plug + Plug

SB-102 Model (American Standard)

Includes accessories.
Accessories available separately.

SB-102P

Plug

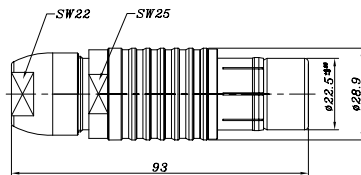

Part Number

SB-102P-0.81/3.7/9.5

Part Number

SB-102J-0.8/3.7/9.5

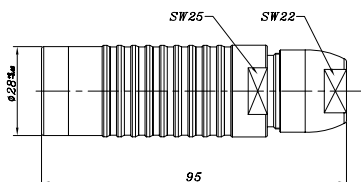

SB-102J



Jack

SB-770 Model (American Standard)

Includes accessories.
Accessories available separately.

SB-770P

Plug

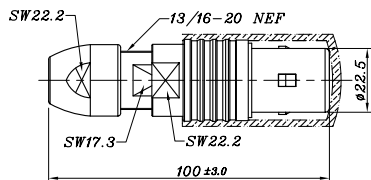

Part Number

SB-770P-0.81/3.7/9.2

SB-770P-1.63/7.9/13.2

Part Number

SB-770J-0.81/3.7/9.2

SB-770J-1.63/7.9/13.2

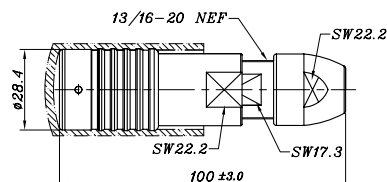

SB-770J



Jack

Specifications subject to change without notice. Consult Sam Woo Electronics for the latest specifications.

SB Series(accessories) – Triaxial

SB-101 Accessory

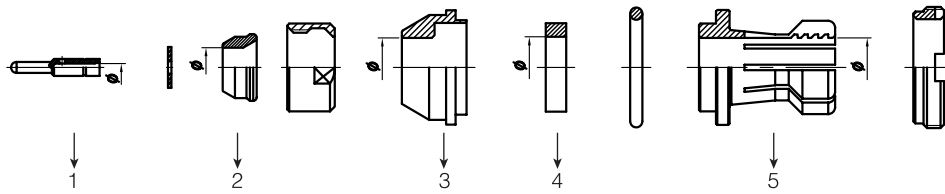

Part Number	Diameter(Ø)				
	1	2	3	4	5
SB-101-1.0 / 4.5 / 8.7A	1.15	5.8	8.7	8.8	8.7
SB-101-1.0 / 4.5 / 9.4A	1.15	5.8	9.4	9.4	9.4
SB-101-1.4 / 4.5 / 9.4A	1.5	5.8	9.4	9.4	9.4
SB-101-1.4 / 6.6 / 11.3A	1.5	7.5	11.3	10.3	11.3

SB-102 Accessory

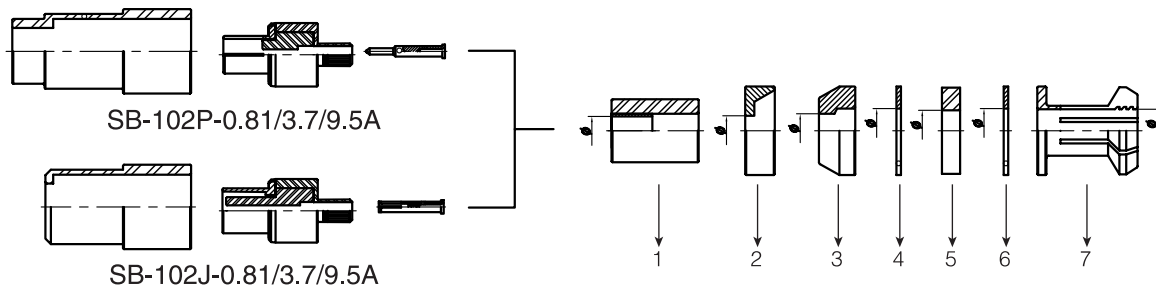

Part Number	Diameter(Ø)						
	1	2	3	4	5	6	7
SB-102P-0.81/3.7/9.5A	6.3	6.6	7.5	9.8	9.0	9.8	9.5
SB-203J-0.81/3.7/9.5A							

SB-770 Accessory

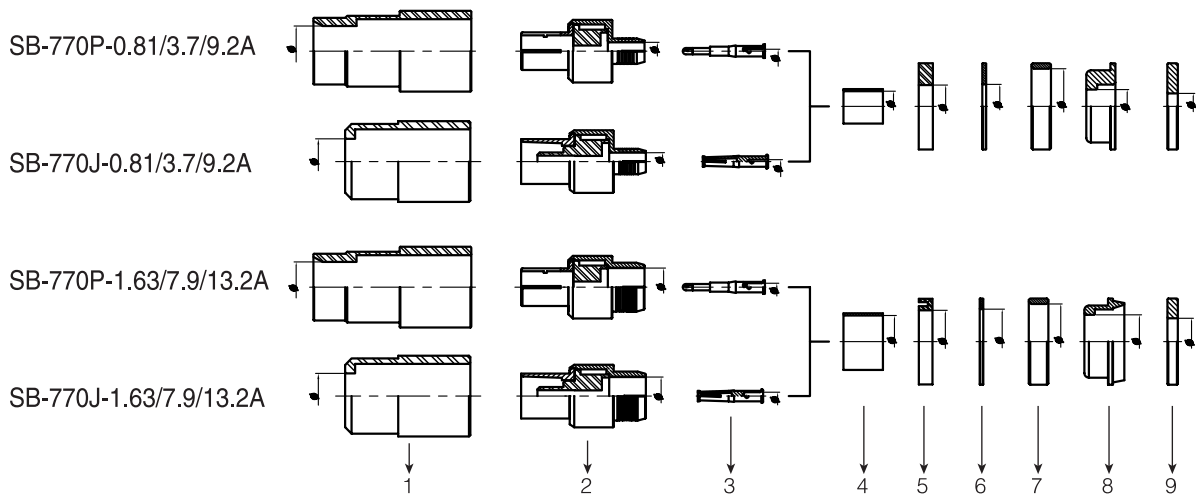

Part Number	Diameter(Ø)								
	1	2	3	4	5	6	7	8	9
SB-770P-0.81/3.7/9.2A	11.1	3.9	0.85	6.7	9.4	9.7	16.65	7.4	5.7
SB-770J-0.81/3.7/9.2A				10					
SB-770P-1.63/7.9/13.2A	11.1	8.4	1.7	11.5	13.8	14.3	16.65	11.8	10.3
SB-770J-1.63/7.9/13.2A				10					

Specifications subject to change without notice. Consult Sam Woo Electronics for the latest specifications.

SB-101P BOOT

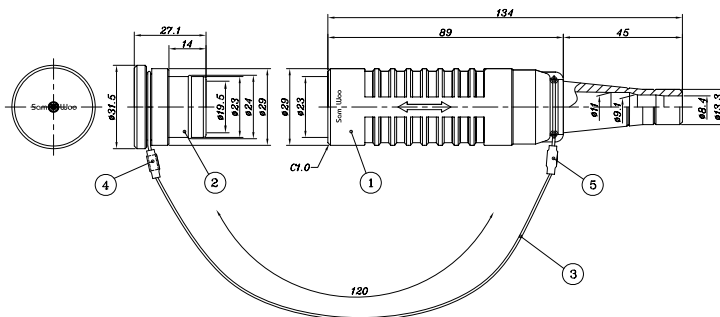

SB-101J BOOT

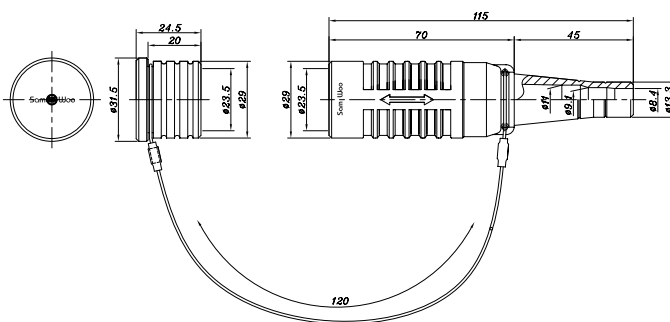

SB-101J CAP

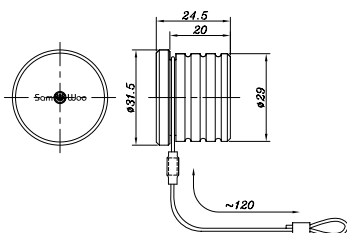
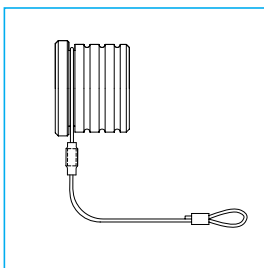

SB-101P CAP

