

B Model Performance / Mini-map – SP Series

Performance

Performance	Endurance	Humidity	Temperature Range	Vibration Resistance	Shock Resistance	Corrosion Test	Mated IP Rating
Value	>5,000 cycles	95%rh 140° F	-67° F +482° F	10~2000Hz, 15g	100g, 6ms	>144h	IP50

Mini-map

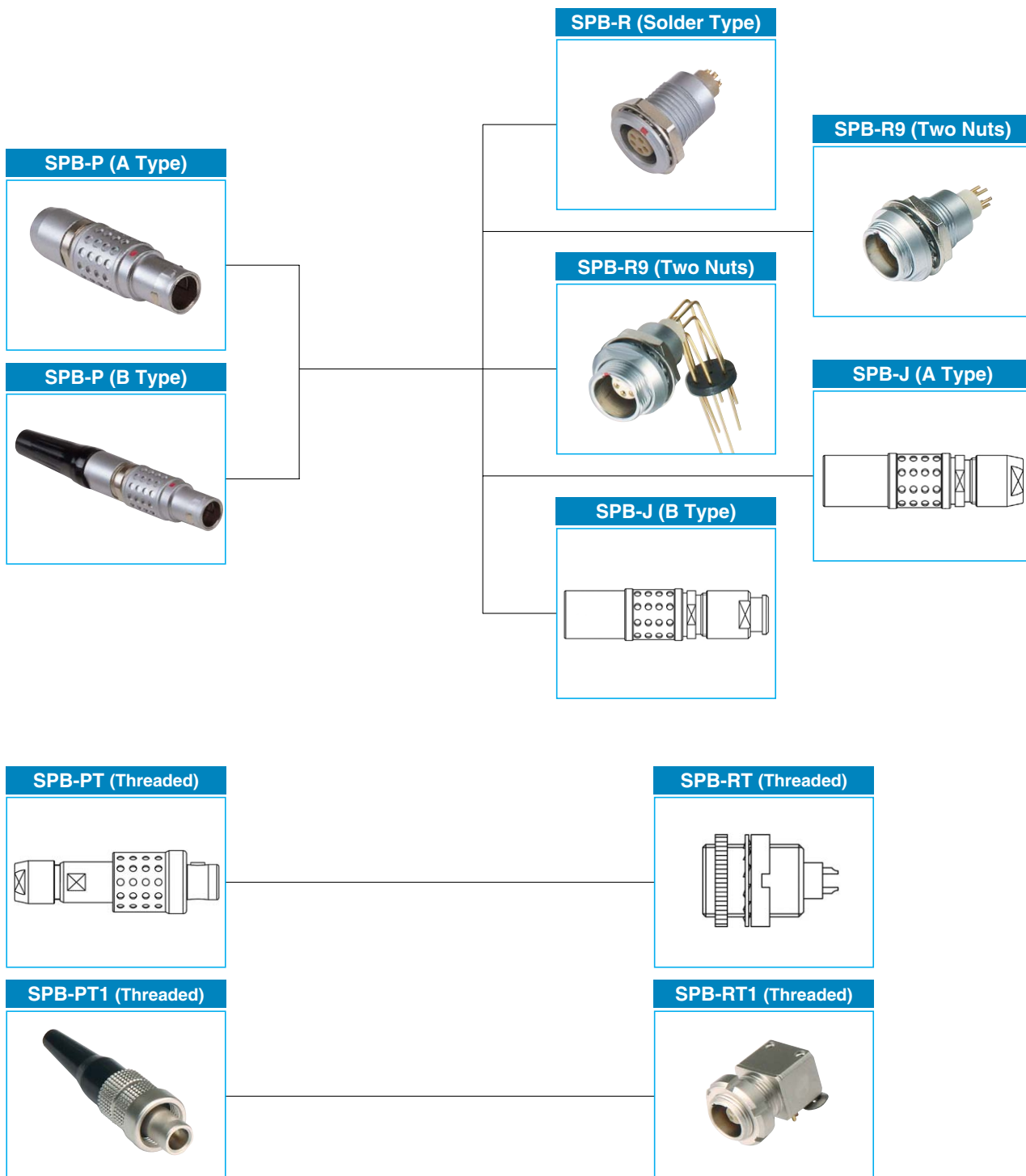

Specifications subject to change without notice. Consult Sam Woo Electronics for the latest specifications.

SP Series – B Model (Size & Shell Selection)

SPB Plug

SPB (A Type)

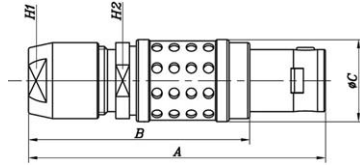

Product Number						A	B	ØC	H1	H2
SPB-	00	P	P	A		28.5	20.5	6.4	5.5	5.0
SPB-	0	P	P	A		36.0	26.0	9.5	8.0	7.0
SPB-	1	P	P	A		43.0	32.0	12.0	10.9	9.0
SPB-	3	P	P	A		58.0	43.0	18.0	15.0	14.0

Material : Page 54
Collet code : Page 54
Contact code : Page 46

SPB (B Type)

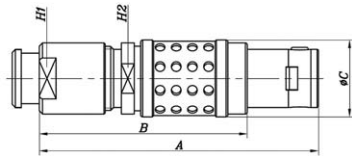

Product Number						A	B	ØC	H1	H2
SPB-	0	P	P	B		35.0	25.0	9.5	8.0	7.0
SPB-	1	P	P	B		42.0	33.0	12.0	10.0	9.0
SPB-	3	P	P	B		56.5	41.5	18.0	15.0	14.0

Material : Page 54
Collet code : Page 54
Contact code : Page 46

SPB Receptacle

SPB (Solder Type)

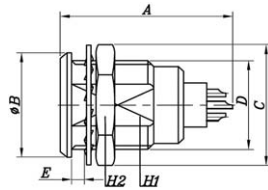

Product Number						A	ØB	C	D	E	H1	H2
SPB-	00	R	S			15.5	8.0	10.3	M7×0.5P	5.5	6.3	9.0
SPB-	0	R	S			20.7	10.0	12.5	M9×0.6P	7.0	7.5	11.0
SPB-	1	R	S			23.0	14.0	16.0	M12×1.0P	7.5	10.5	14.0
SPB-	3	R	S			30.7	22.0	25.0	M18×1.0P	11.5	16.5	22.0

Material : Page 54
Contact code : Page 46

SPB (Two Nut PCB)

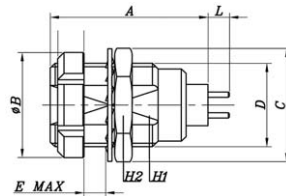

Product Number						A	ØB	C	D	E	H1	H2
SPB-	0	R	S	B		16.4	12.0	12.5	M9×0.6P	5.5	8.2	11.0
SPB-	1	R	S	B		19.8	16.0	16.0	M12×1.0P	6.0	10.5	14.0
SPB-	3	R	S	B		25.8	24.0	25.0	M18×1.0P	9.0	16.5	22.0

Material : Page 54
Contact code : Page 46

SPB (Two Nut Right-Angle-PCB)

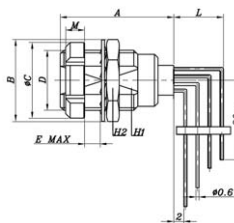

Product Number						A	B	ØC	D	E	H1	H2
SPB-	0	R	S	B		18.3	12.5	12.0	M9×0.6P	2.4	8.2	11.0
SPB-	1	R	S	B		20.3	19.5	16.0	M12×1.0P	6.0	10.5	14.0
SPB-	3	R	S	B		25.8	25.0	24.0	M18×1.0P	9.0	16.5	22.0

Material : Page 54
Contact code : Page 46

! Length (L) depends on number of contacts

SPB Jack

SPB (A Type)

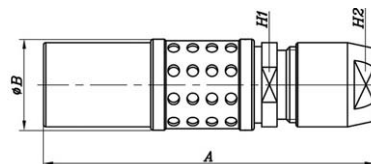
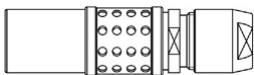

Product Number						A	ØB	H1	H2
SPB-	00	J	S	A		27.0	6.4	5.5	5.0
SPB-	0	J	S	A		35.5	9.5	8.0	7.0
SPB-	1	J	S	A		40.5	12.5	10.0	9.0
SPB-	3	J	S	A		56.0	19.0	15.0	14.0

Material : Page 54
Collet code : Page 54
Contact code : Page 46

SPB (B Type)

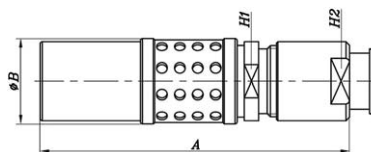
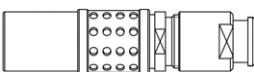

Product Number						A	ØB	H1	H2
SPB-	00	J	S	B		26.0	6.4	5.5	5.0
SPB-	0	J	S	B		34.5	9.5	8.0	7.0
SPB-	1	J	S	B		39.5	12.5	10.0	9.0
SPB-	3	J	S	B		54.5	19.0	15.0	15.0

Material : Page 54
Collet code : Page 54
Contact code : Page 46

B Model (Screw Mounting) – SP Series

SPB Plug(Threaded-mounting)

SPB (Cable Collet, 1 key)

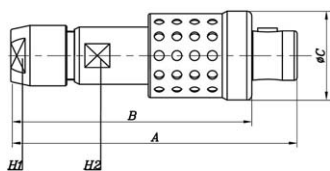
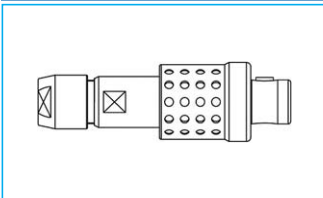

Product Number	A	B	ØC	H1	H2
[SPB]-[00][PT]-[P]-[A]-[]	28.5	24.0	9.0	5.0	5.0
[SPB]-[00][PT(A)]-[P]-[A]-[]					

Material : Page 54
Collet code : Page 54
Contact code : Page 46
! (A) indicates two key body

SPB (Crimp Type, 2 key)

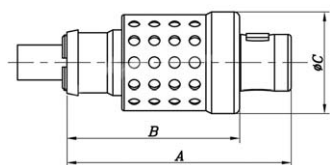

Product Number	A	B	ØC
[SPB]-[00][PT1]-[P]-[C]-[]	20.0	15.4	9.0
[SPB]-[00][PT1(A)]-[P]-[C]-[]			

Material : Page 54
Collet code : Page 54
Contact code : Page 46
! (A) indicates two key body

SPB Receptacle (Threaded-mounting)

SPB(1 Key)

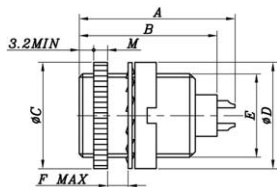
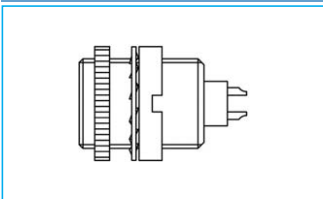

Product Number	A	B	C	ØD	E	F	M
[SPB]-[00][RT]-[S]-[]	15.5	13.7	9.5	9.0	M7×0.5P	4.2	2.0
[SPB]-[0][RT1]-[S]-[]							

Material : Page 54
Contact code : Page 46
! (A) indicates two key body

SPB(2 Key)

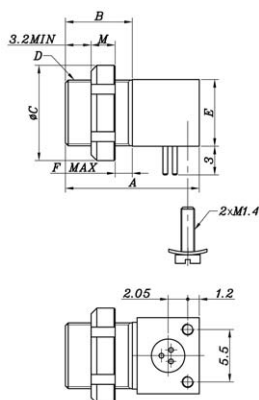

Product Number	A	B	ØC	D	E	F	M
[SPB]-[00][R]-[S]-[]	14.0	7.0	10.0	M7×0.5P	7.0	1.8	2.5
[SPB]-[0][RT1(A)]-[S]-[]							

Material : Page 54
Contact code : Page 46
! (A) indicates two key body

SPB Antenna

SPB-450 Antenna

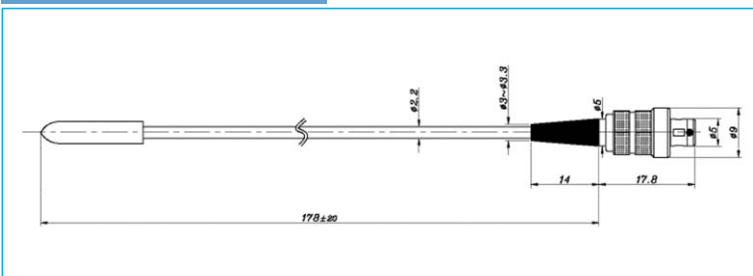

Electrical performance	Specifications
Frequency Range	450 MHz~900MHz
Connector	SPB-00PT1
Nominal Impedance	50 ohm
Radiation Pattern	Omni-Directional
Polarization	Vertical
V.S.W.R	Less than 1:2.0
Gain	0 dBi

For more information on antenna, refer to catalogue p. 134.

- Cutting chart by frequency available.
- Antenna caps included in various colors.

Specifications subject to change without notice. Consult Sam Woo Electronics for the latest specifications.

SP Series – B Model Contact Code

Contact Code

Series & Model	Size	Contact Code	Current	Impedance	Cable Group	VSWR (GHz)	Contact Arrangement
SPB	00	250	4A	50	1-2-5-6	1.09+11.f	

Series & Model	Size	Contact Code	Current	Contact Ø	No. of Contacts	Contact Arrangement
SPB	00	302	5A	0.5	2	
		303	3A	0.5	3	
		304	2A	0.5	4	
	0	302	10A	0.9	2	
		303	8A	0.9	3	
		304	7A	0.7	4	
		305	6.5A	0.7	5	
		306	2.5A	0.7	6	
		307	2.5A	0.7	7	
		1	302	15A	1.3	2
	303		12A	1.3	3	
	304		10A	0.9	4	
	305		9A	0.9	5	
	306		7A	0.7	6	
	307		7A	0.7	7	
	308		5A	0.7	8	

Series & Model	Size	Contact Code	Number of Contacts	Contact Ø	Current	Coax cable group / Wire max AWG	Coax Impedance & Contact Type	Contact Arrangement
SPB	3	846	2 coax	0.7	2A	1-2-3	50Ω Type C	
			6LV	0.9	8A	22		

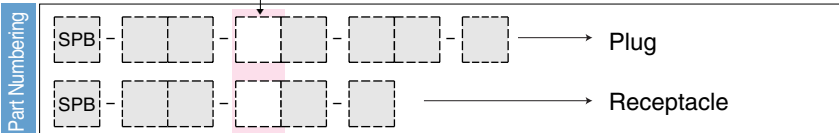

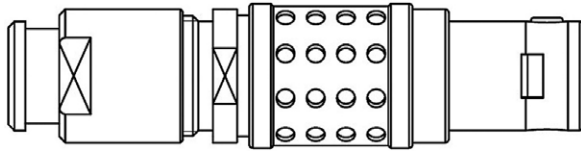

SPS Series

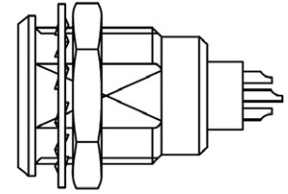

SPS Part Numbering - Hermaphroditic keying system

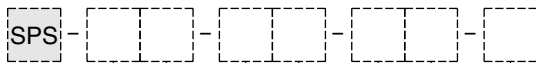

Size

00,0,1,2,3

Body Type

P : Plug

R : Receptacle

J : Jack

R9 : Two-unt Receptacle

Contact Code

See page 50

Contact Type

P : Pin/Male

S : Socket/Female

SP : Socket/Female and Pin/Male

SPB : PCB Socket/Female and Pin/Male

LSB : Right-angle PCB Socket/Female

LSPB : Right-angle PCB Socket/Female and Pin/Male

Screw Cap Code (Plug and Jack only)

A : Screw Cap Terminated

B : Screw Cap + Boot type

Collet Code (Plug and Jack only)

See page 54

Material and Socket Contact Cut Code

See page 54

Specifications subject to change without notice. Consult Sam Woo Electronics for the latest specifications.

SP Series – S Model Performance / Mini-map

Performance

Performance	Endurance	Humidity	Temperature Range	Vibration Resistance	Shock Resistance	Corrosion Test	Mated IP Rating
Value	>5,000 cycles	95%rh 140° F	-67° F +482° F	10~2000Hz, 15g	100g, 6ms	>144h	IP50

Mini-map

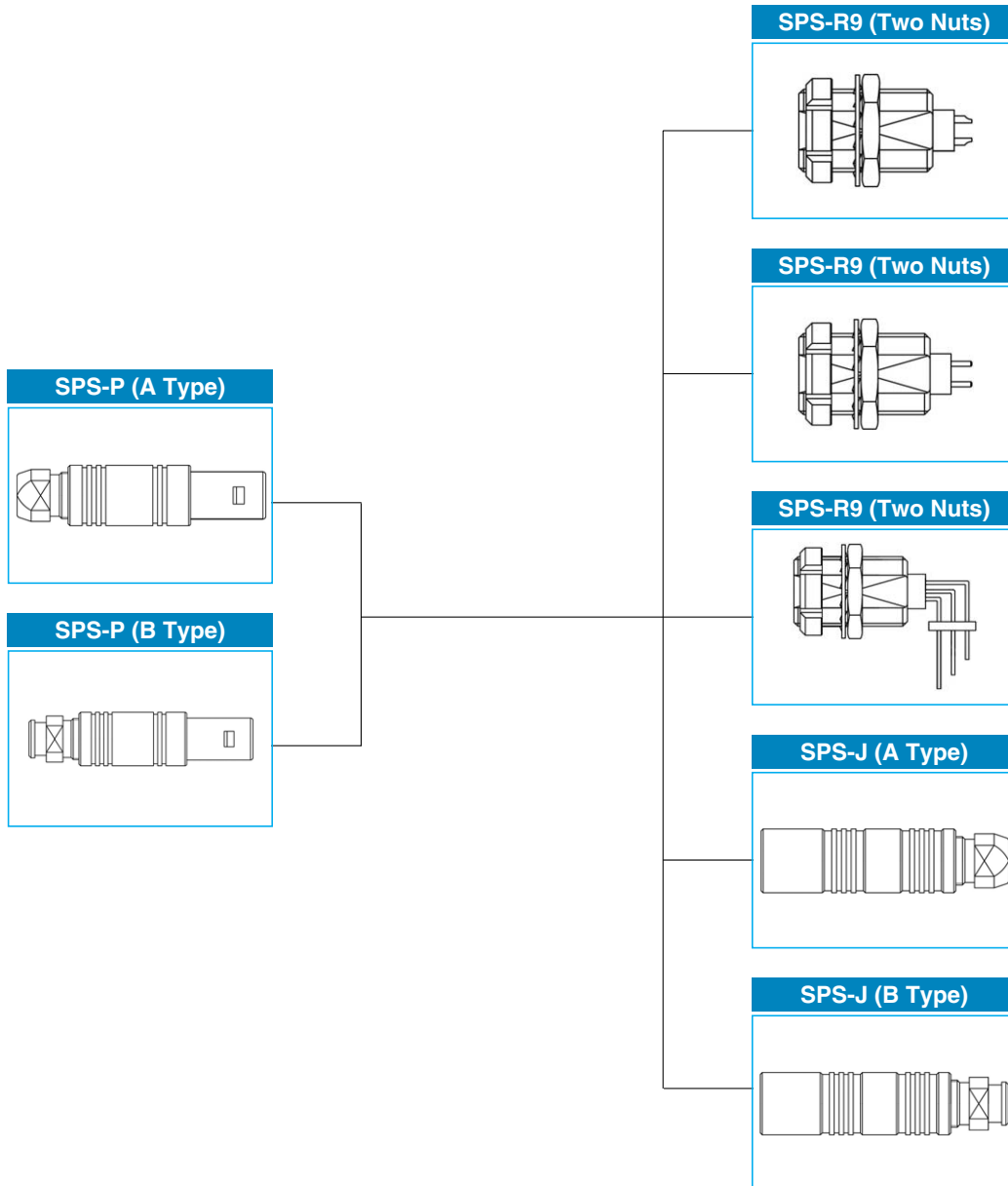

Specifications subject to change without notice. Consult Sam Woo Electronics for the latest specifications.

S Model (Size & shell selection) – SP Series

SPS Plug

SPS (A Type)

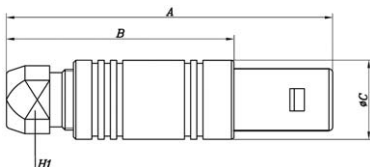
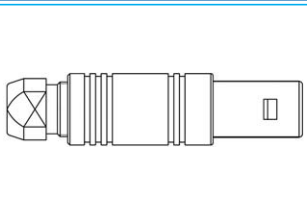

Product Number					A	B	ØC	H1
SPS	00	P	A		26.0	18.0	6.4	4.5
SPS	0	P	A		34.5	24.5	9.0	6.5
SPS	1	P	A		42.5	31.5	12.0	8.5
SPS	2	P	A		52.0	40.0	14.8	11.0
SPS	3	P	A		61.0	46.0	17.8	14.0

Material : Page 54
 Collet code : Page 54
 P : Pin/Male, SP : Socket/Female and Pin/Male Contact
 Contact code : Page 50

SPS (B Type)

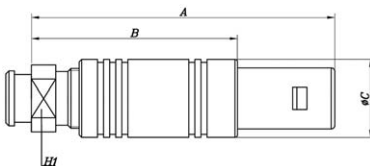
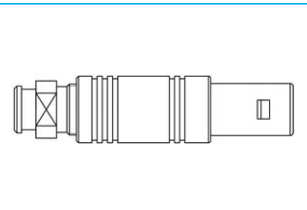

Product Number					A	B	ØC	H1
SPS	00	P	B		26.0	18.0	6.4	6.0
SPS	0	P	B		34.5	24.5	9.0	7.0
SPS	1	P	B		42.5	31.5	12.0	9.0
SPS	2	P	B		52.0	40.0	14.8	12.0
SPS	3	P	B		61.0	46.0	17.8	14.0

Material : Page 54
 Collet code : Page 54
 P : Pin/Male, SP : Socket/Female and Pin/Male Contact
 Contact code : Page 50

SPS Receptacle

SPS (Two Nut Solder)

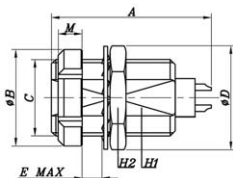
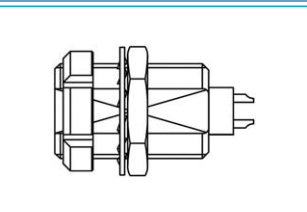

Product Number		A	ØB	C	ØD	E	H1	H2
SPS	0	17.5	12.0	M9×0.6P	12.5	8.5	8.2	11.0
SPS	1	20.2	16.0	M12×1.0P	16.0	10.0	10.5	14.0
SPS	2	24.5	19.5	M12×1.0P	20.0	11.0	13.5	17.0
SPS	3	29.0	24.0	M18×1.0P	25.2	14.0	16.5	22.0

Material : Page 54
 S : Socket/Female, SP : Socket/Female and Pin/Male Contact
 Contact code : Page 50

SPS (Two Nut PCB)

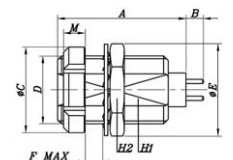
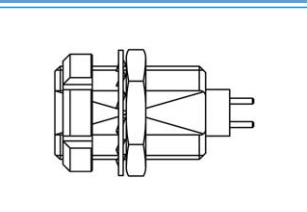

Product Number		A	B	ØC	D	ØE	F	H1	H2
SPS	0	15.0	3.0	12.0	M9×0.6P	12.5	8.5	8.2	11.0
SPS	1	17.5	3.0	16.0	M12×1.0P	16.0	10.0	10.5	14.0
SPS	2	20.0	3.0	20.0	M15×1.0P	19.5	11.0	13.5	17.0
SPS	3	24.0	3.0	24.0	M18×1.0P	25.2	14.0	16.5	22.0

Material : Page 54
 SB : PCB Socket/Female
 SPB : PCB Socket/Female and Pin/Male Contact
 Contact code : Page 50

SPS (Two Nut Right Angle PCB)

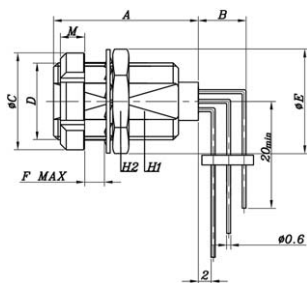
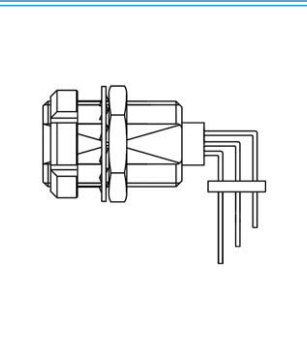

Product Number		A	B	ØC	D	ØE	F	H1	H2
SPS	0	15.0	①	12.0	M9×0.6P	12.5	8.5	8.2	11.0
SPS	1	17.5	①	16.0	M12×1.0P	16.0	10.0	10.5	14.0
SPS	2	20.0	①	20.0	M15×1.0P	19.5	11.0	13.5	17.0
SPS	3	24.0	①	24.0	M18×1.0P	25.2	14.0	16.5	22.0

Material : Page 54
 LSB : Right-angle PCB Socket/Female
 LSPB : Right-angle PCB Socket/Female and Pin/Male Contact
 Contact code : Page 50

Specifications subject to change without notice. Consult Sam Woo Electronics for the latest specifications.

SP Series – S Model Contact Code

SPS Jack

SPS (A Type)

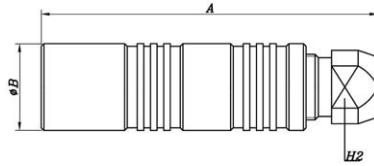
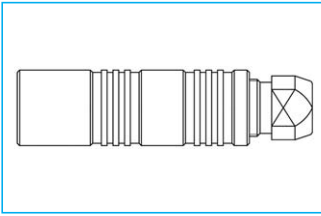

Product Number				A	ØB	H2
SPS	100	J	A	25.0	6.5	4.5
SPS	10	J	A	33.5	8.9	6.5
SPS	11	J	A	40.5	11.9	8.5
SPS	12	J	A	50.0	14.8	11.0
SPS	13	J	A	59.0	17.8	14.0

Material : Page 54
 Collet code : Page 54
 S : Socket/Female, SP : Socket/Female and Pin/Male Contact
 Contact code : Page 50

SPS (B Type)

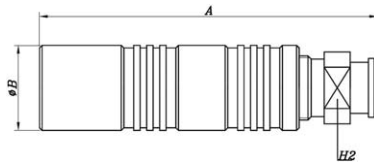
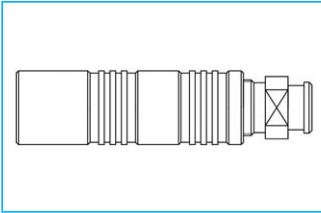

Product Number				A	ØB	H2
SPS	100	J	B	25.0	6.5	6.0
SPS	10	J	B	33.5	8.9	7.0
SPS	11	J	B	40.5	11.9	9.0
SPS	12	J	B	50.0	14.8	12.0
SPS	13	J	B	59.0	17.8	14.0

Material : Page 54
 Collet code : Page 54
 S : Socket/Female, SP : Socket/Female and Pin/Male Contact
 Contact code : Page 50

Contact Code (single contact)

Series & Model	Size	Contact Code	Current	Contact Ø	Pin Contact Arrangement	Socket Contact Arrangement
SPS	00	113	8A	1.3		
	0	116	12A	1.6		
	1	120	18A	2.0		
		130	25A	3.0		

Contact Code (coaxial)

Series & Model	Size	Contact Code	Current	Impedance	Cable Group	VSWR (GHz)	Contact Arrangement
SPS	00	250	4A	50	1-3-5-6	1.09+11.f	
	0	250	6A	50	1-2-3-4	1.02+25f	
	1	250	12A	50	1-2-3-4-6	1.01+0.8f	
		275	10A	75	5-6-7	1.02+0.8f	

Contact Code (multi-contact)

Series & Model	Size	Contact Code	Current	Contact Ø	No. of Contacts	Contact Arrangement
SPS	00	302	10A	0.9	2	
	1	302	15A	1.3	2	
		304	10A	0.9	4	
	2	310	7A	0.9	10	
	3	302	23A	2.0	2	

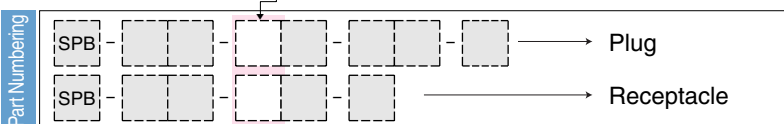

Specifications subject to change without notice.
 Consult Sam Woo Electronics for the latest specifications.

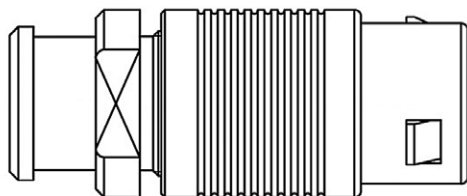

SPC Series

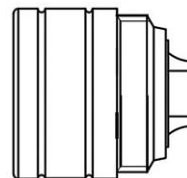

SPC Part Numbering - Hermaphroditic keying system (short dimension)

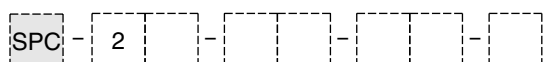

Size

2

Body Type

P : Plug PE : Fixed plug
R3 : Receptacle J : Jack

Contact Code

306 : 3 Socket/Female & 3 Pin/Male

Contact Type

SP : Socket/Female and Pin/Male contact

Screw Cap Code (Plug and Jack only)

A : Screw Cap Terminated
B : Screw Cap + Boot type

Collet Code (Plug and Jack only)

See page 54

Material and Socket Contact Cut Code

See page 54

Performance

Performance	Endurance	Humidity	Temperature Range	Corrosion Test	Mated IP Rating
Value	>5,000 cycles	95%rh 140°F	-67°F +482°F	>144h	IP50

Specifications subject to change without notice. Consult Sam Woo Electronics for the latest specifications.

SP Series – C Model Mini-map/Contact Code

Mini-map

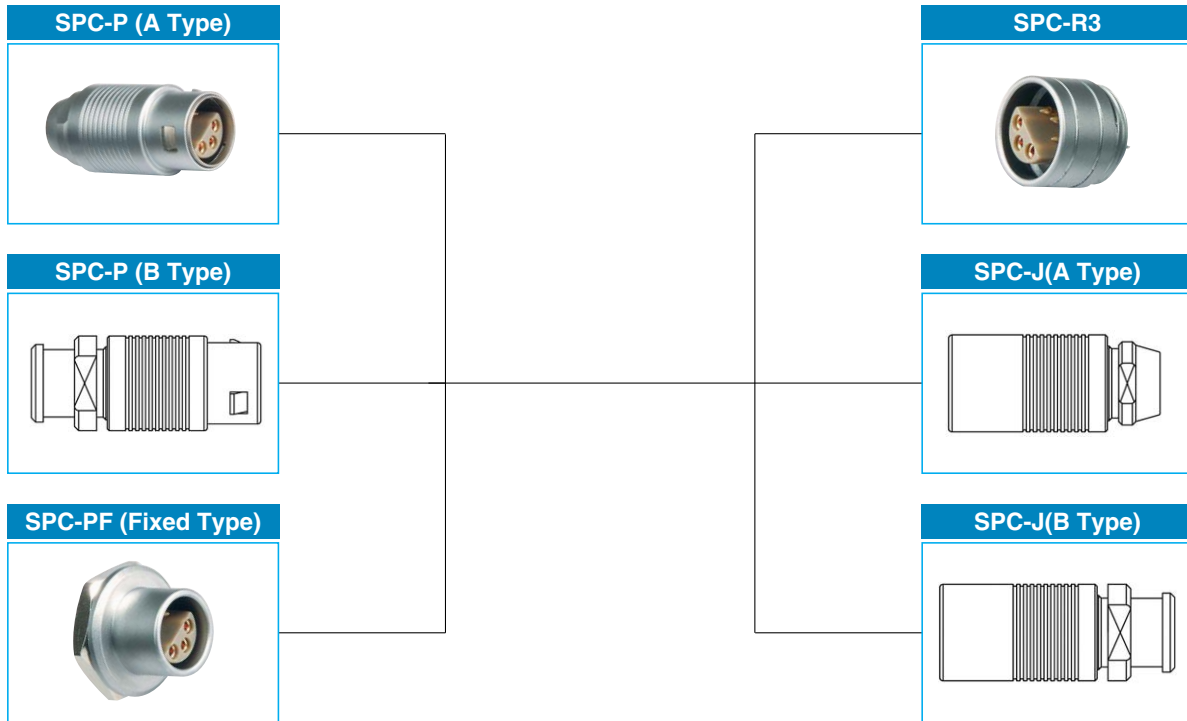

Contact Code

Series & Model	Size	Contact Code	Current	Contact Ø	No. of Contacts	Contact Arrangement
SPC	2	306	12A	1.3	6	

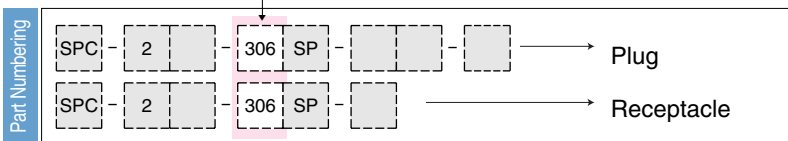

Specifications subject to change without notice. Consult Sam Woo Electronics for the latest specifications.

C Model (Size & Shell Selection) – SP Series

SPC Plug

SPC (A Type)

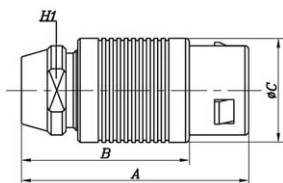

Product Number	A	B	ØC	H1
[SPC]-[2]-[P]-[306]-[SP]-[A]-[]	30	22	14	10.5

Material : Page 54
Collet code : Page 54

SPC (B Type)

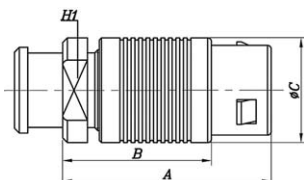
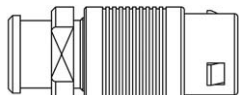

Product Number	A	B	ØC	H1
[SPC]-[2]-[P]-[306]-[SP]-[B]-[]	28.4	20.4	14.	12

Material : Page 54
Collet code : Page 54

SPC (Fixed Type)

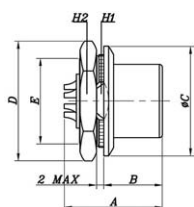

Product Number	A	B	ØC	D	E	H1	H2
[SPC]-[2]-[P]-[306]-[SP]-[B]-[]	17	9.5	18	19.5	M15×1P	13.8	17

Material : Page 54
Collet code : Page 54

SPC Receptacle

SPC (Type 3)

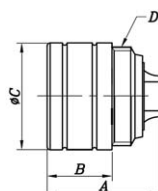

Product Number	A	B	ØC	D
[SPC]-[2]-[R3]-[306]-[SP]-[]	14.2	8.5	14.0	M13×0.75P

Material : Page 54

SPC Jack

SPC (A Type)

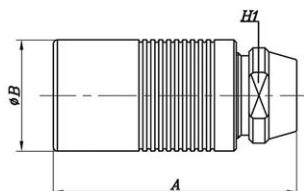
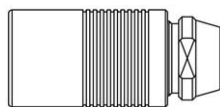

Product Number	A	ØB	H1
[SPC]-[2]-[J]-[306]-[SP]-[A]-[]	28	14	1.5

Material : Page 54
Collet code : Page 54

SPC (B Type)

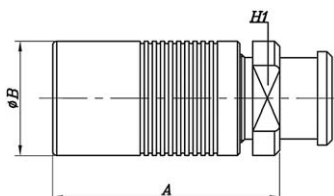
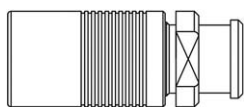

Product Number	A	ØB	H1
[SPC]-[2]-[J]-[306]-[SP]-[B]-[]	26.4	14	12

Material : Page 54
Collet code : Page 54

Specifications subject to change without notice. Consult Sam Woo Electronics for the latest specifications.

SP Series – Collet Code / Material Code

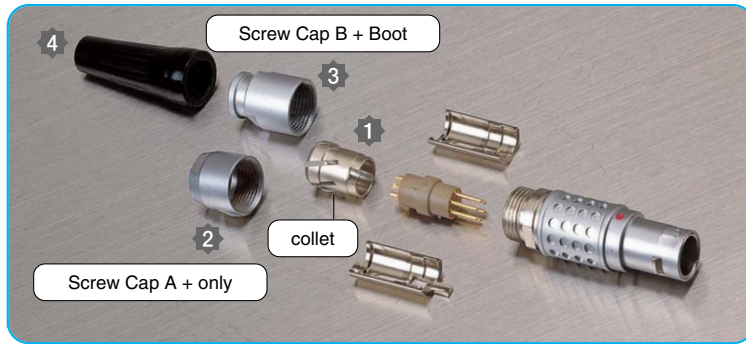

- 1) Collet
- 2) Screw Cap A
- 3) Screw Cap B
- 4) Boot
- * Select Screw Cap A
or
Screw Cap B + Boot

Collet Code Information

Series & Model	Size	Collet Code	Collet				Screw Cap Type A	Screw Cap Type B	Boot for Collet Type B				
			Cable Ø		Dimension				Cable Ø				
			ØA	ØB	max	min			ØA	L	max	min	
			ØA	ØB	max	min			ØA	L	max	min	
SPB	00	D30	3.1	2.8	3.0	2.5	●						
		D35	3.5	2.8	3.4	2.9	●						
		D56	5.6	4.7	5.5	5.1	●						
	1	D42	4.2		4.0	3.1	●	●	3.0	30	3.4	3.0	
									3.5	30	3.9	3.5	
		D52	5.2		5.0	4.1	●	●	4.0	30	4.4	4.0	
									4.5	30	4.9	4.5	
3	M52			5.0	4.1	●	●	5.4	30	6.0	5.4		
								6.5	30	7.0	6.5		
SPS	00	L29	2.9		2.8	2.4	●	●	3.0	30	3.4	3.0	
		L31	3.1		3.0	2.6	●	●	3.5	30	3.9	3.5	
	0	L42	4.2		4.1	3.3	●	●	4.0	30	4.4	4.0	
		L44	4.4		4.3	3.5	●	●	4.5	30	4.9	4.5	
	1	L62	6.2		6.1	5.3	●	●	5.4	30	6.0	5.4	
SPC	2	L37	3.7		3.6	3.2	●	●	5.0	36	5.5	5.0	
								6.0	36	6.5	6.0		

Collet Code

Material Code (For all SP series)

Pin		Insulator		Socket Cut		Latch Sleeve	
code 1	Material	code 2	Material	code 3	Method	code 4	Material
E	Beryllium	L	PEEK	S	Side	Y	Beryllium
A	Brass	N	PA	H	Half	R	Brass
		T	Teflon			U	PSU

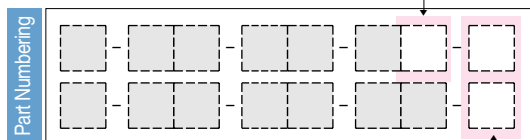

Material Code

Material Code Instruction

- Plug(Jack) + Male Contact : Code 1, 2, 4
- Plug(Jack) + Female Contact : Code 1, 2, 3, 4
- Plug(Jack) + Male & Female Contact : Code 1(Female Contact), Code 1(Male Contact), 2, 3, 4
- Receptacle + Male Contact : Code 1, 2
- Receptacle + Female Contact : Code 1, 2, 3
- Receptacle + Male & Female Contact : Code 1(Female Contact), Code 1(Male Contact), 2, 3

Specifications subject to change without notice. Consult Sam Woo Electronics for the latest specifications.

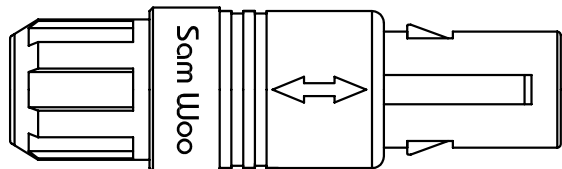

SPP Series

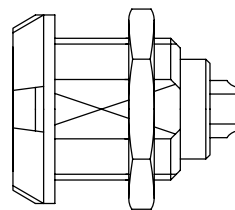

SPP Part Numbering - Plastic connector

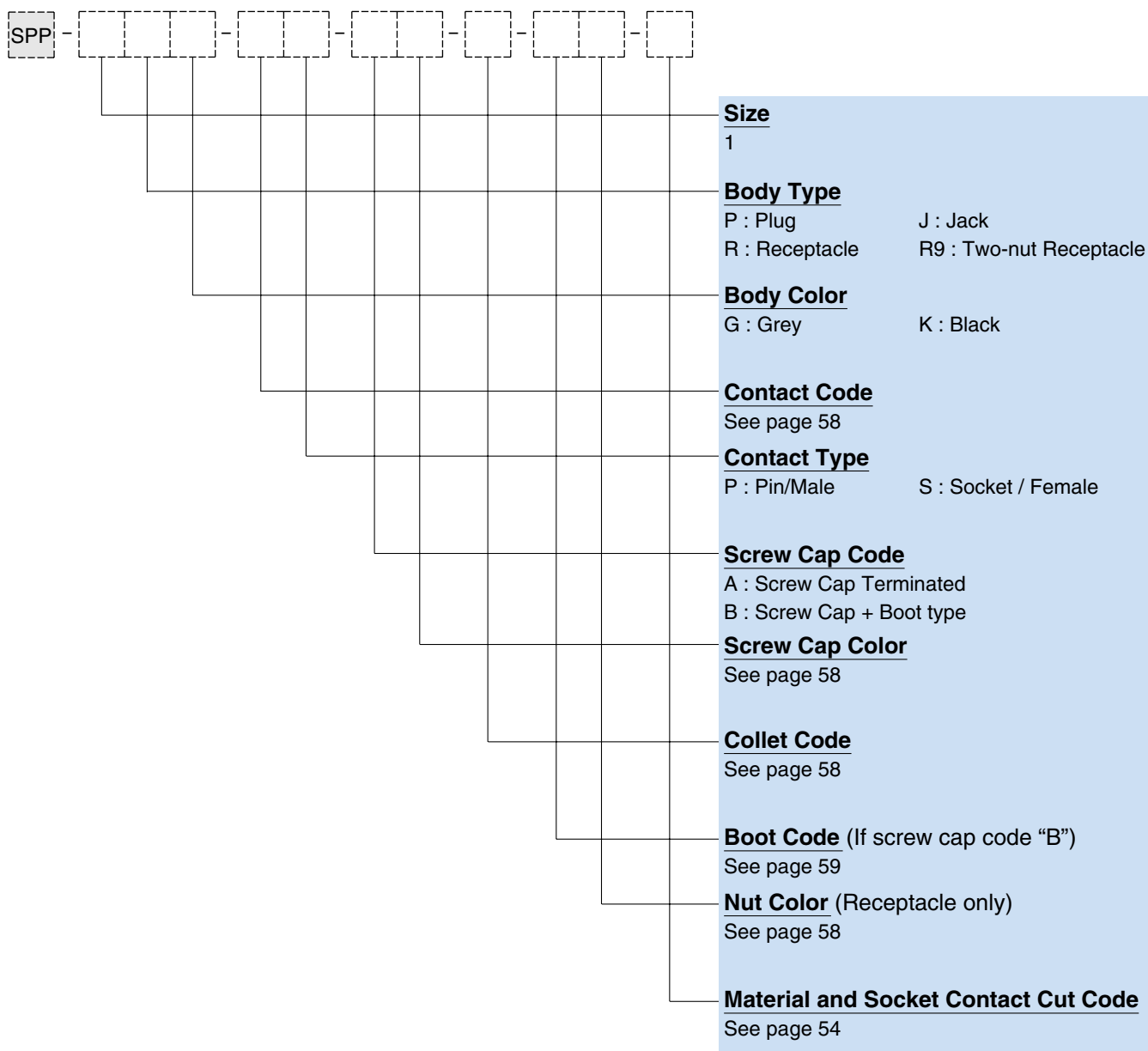

Specifications subject to change without notice. Consult Sam Woo Electronics for the latest specifications.

SP Series – P Model Performance / Mini-map

Performance

Performance	Average retention force when pulling on the cable	Cable retention force (depends on cable construction)	Endurance	Temperature Range	Mated IP Rating
Value	90N	>1,000 cycles	>1,000 cycles	-50°C to + 150°C	IP50

Mini-map

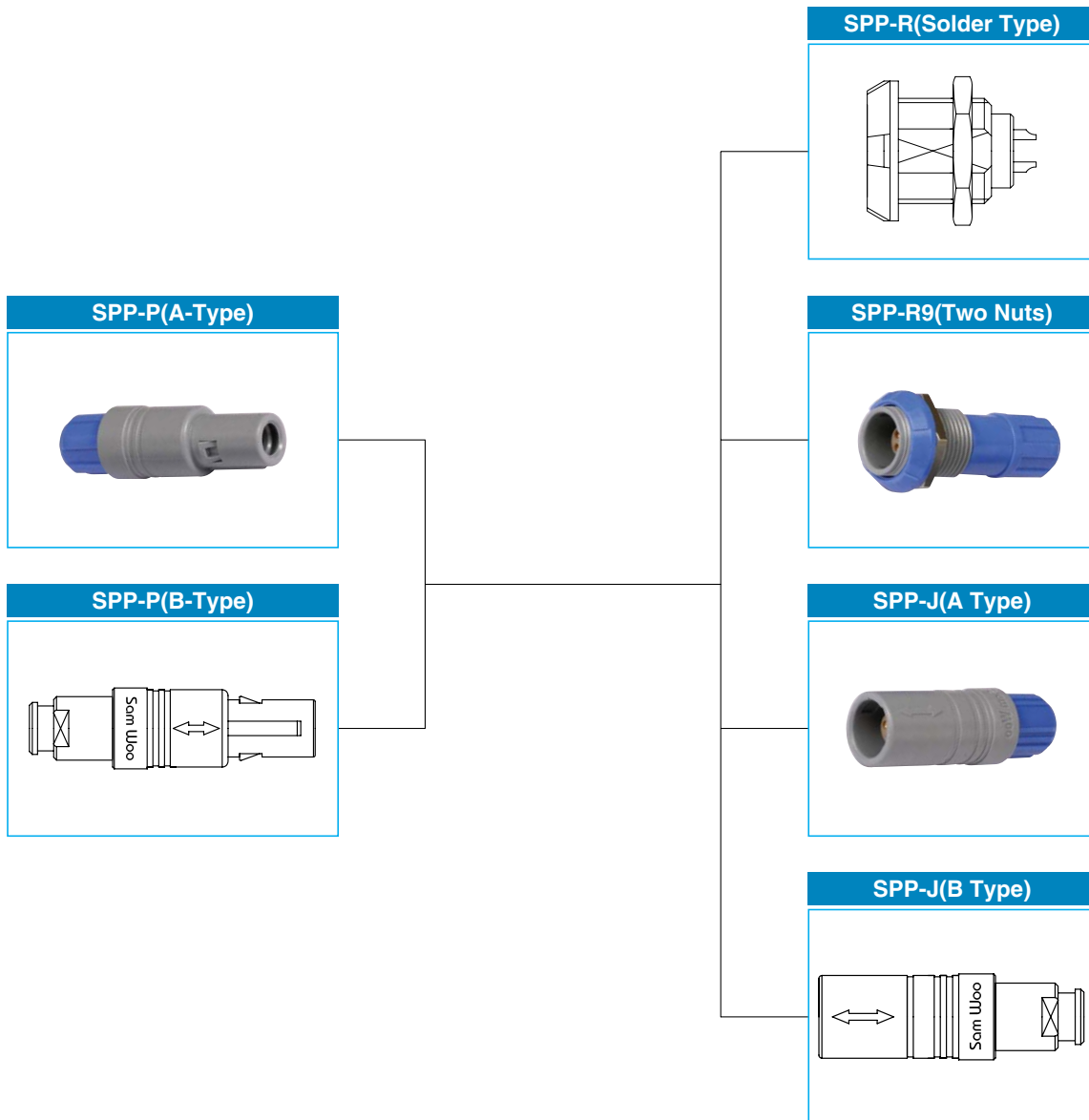

Specifications subject to change without notice. Consult Sam Woo Electronics for the latest specifications.

P Model (Size & shell selection) – SP Series

SPP Plug

SPP-P(A-Type)

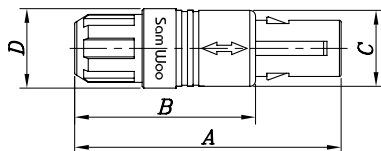

Product Number	A	B	ØC	ØD
SPP-TIP-PAI	45.0	30.0	13.4	14.0

Material & Socket contact Cut code : Page 54
 Collet Code : Page 58
 Screw Cap Color : Page 58
 Contact Code : Page 58
 Body Color : G(Grey) or K(Black)

SPP-P(B-Type)

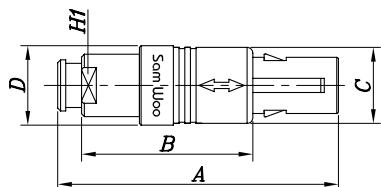
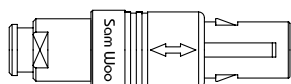

Product Number	A	B	ØC	ØD	H1
SPP-TIP-PBI	35.0	28.7	13.4	14.0	9.0

Material & Socket contact Cut code : Page 54
 Collet Code : Page 58
 Screw Cap Color : Page 58
 Contact Code : Page 58
 Body Color : G(Grey) or K(Black)

SPP Receptacle

SPP-R(Solder Type)

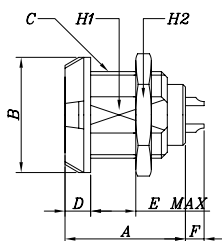
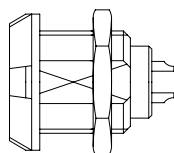

Product Number	A	B	C	D	E	F	H1	H2
SPP-TIR-IS	20.5	18.5	M14×1.0P	4.0	9.0	2.5	12.5	17.0

Material & Socket contact Cut code : Page 54
 Collet Code : Page 58
 Body Color : G(Grey) or K(Black)

SPP-R9(Two Nuts)

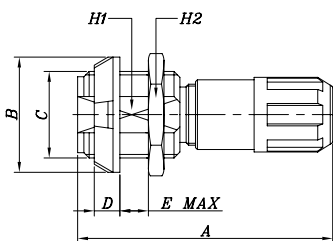

Product Number	A	B	C	D	E	H1	H2
SPP-TIR9I-SAI	40.0	18.5	M14×1.0P	4.0	9.0	12.5	17.0

Material & Socket contact Cut code : Page 54
 Collet Code : Page 58
 Screw Cap Color : Page 58
 Contact Code : Page 58
 Body Color : G(Grey) or K(Black)

SPP Jack

SPP-J(A-Type)

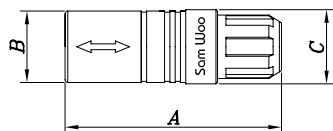

Product Number	A	ØB	ØC
SPP-TIJ-SAI	40.0	13.5	14.0

Material & Socket contact Cut code : Page 54
 Collet Code : Page 58
 Screw Cap Color : Page 58
 Contact Code : Page 58
 Body Color : G(Grey) or K(Black)

SPP-J(B-Type)

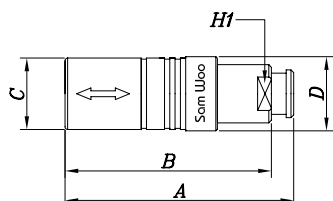









Product Number	A	B	ØC	ØD	H1
SPP-TIJ-SBI	43.0	38.7	13.5	14.0	9.0

Material & Socket contact Cut code : Page 54
 Collet Code : Page 58
 Screw Cap Color : Page 58
 Contact Code : Page 58
 Body Color : G(Grey) or K(Black)

Specifications subject to change without notice. Consult Sam Woo Electronics for the latest specifications.

SP Series – P Model Contact Code

Contact Code

Series & Model	Size	Contact Code	Current	Contact \varnothing	No. of Contacts	Contact Arrangement
SPP	1	302	10A	1.3	2	
		304	8A	0.9	4	
		305	7A	0.9	5	
		306	6A	0.7	6	
		307	5A	0.7	7	
		308	5A	0.7	8	
		309	3A	0.5	9	
		310	3A	0.5	10	
		314	2A	0.5	14	

Screw cap color / Nut color

Code	BK	GY	WH	RD	GN	BU	OR	YE	BR
Color	Black	Grey	White	Red	Green	Blue	Orange	Yellow	Brown

Collet Code

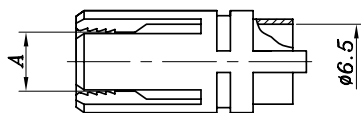

Series & Model	Size	Collet Code	Collet	Cable \varnothing	
				Max	Min
SPP	1	D39	3.9	3.9	2.7
		D52	5.2	5.2	4
		D65	6.5	6.5	5.3

Specifications subject to change without notice. Consult Sam Woo Electronics for the latest specifications.

Boot Part Numbering – SP Series

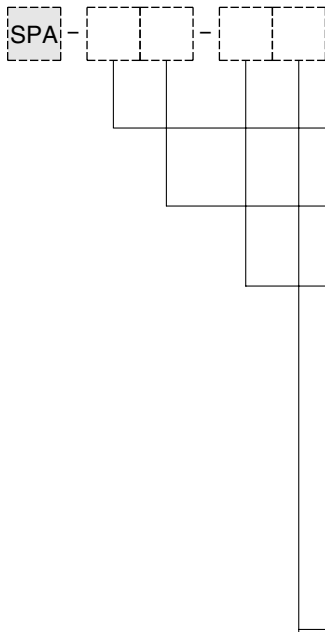

Size

00, 0, 1, 2, 3

Accessory Type

B : Boot

Color Code

BK : Black

GY : Grey

WH : White

RD : Red

GN : Green

BU : Blue

OR : Orange

YE : Yellow

BR : Brown

Boot Size Code

Insert $\varnothing A$ from below chart “Min Cable \varnothing ”

Color Code



* Material : Polyurethane elastomer

* Temperature range in dry atmosphere : -40°C ~ +80°C

Boot Size Code (example with color black)



Boot Part Number	Size	Dimension		Cable \varnothing	
		$\varnothing A$	L	max	min
SPA-0B-BK25		2.5	24	3.4	3
SPA-0B-BK30	0	3	24	3.4	3
SPA-0B-BK35		3.5	24	3.9	3.5
SPA-0B-BK40	0	4	24	3.3	4
SPA-0B-BK45		4.5	24	4.9	4.5
SPA-1B-BK25		2.5	30	2.9	2.5
SPA-1B-BK30	1	3	30	3.4	3
SPA-1B-BK35		3.5	30	3.9	3.5
SPA-1B-BK40		4	30	4.4	4
SPA-1B-BK45		4.5	30	4.9	4.5
SPA-1B-BK54		5.4	30	6	5.4
SPB-1B-BK65		6.5	30	7.0	6.5
SPA-2B-BK50	2	5	36	5.5	5
SPA-2B-BK60		6	36	6.5	6
SPA-3B-BK40	3	4	30	4.4	4
SPA-3B-BK45		4.5	30	4.9	4.5

! To change color from above example, change “BK” to color of preference.

Specifications subject to change without notice. Consult Sam Woo Electronics for the latest specifications.